



# 如何安裝「GRWTH AI」 ( Android系統 )

\*For English version please go to P.14



步驟一：登入Google Play Store

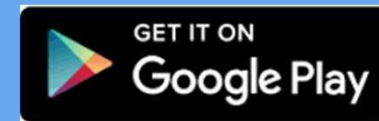



步驟二：於搜尋中輸入「Grwth AI」

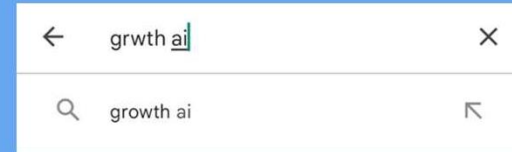



### 步驟三：點選「安裝」

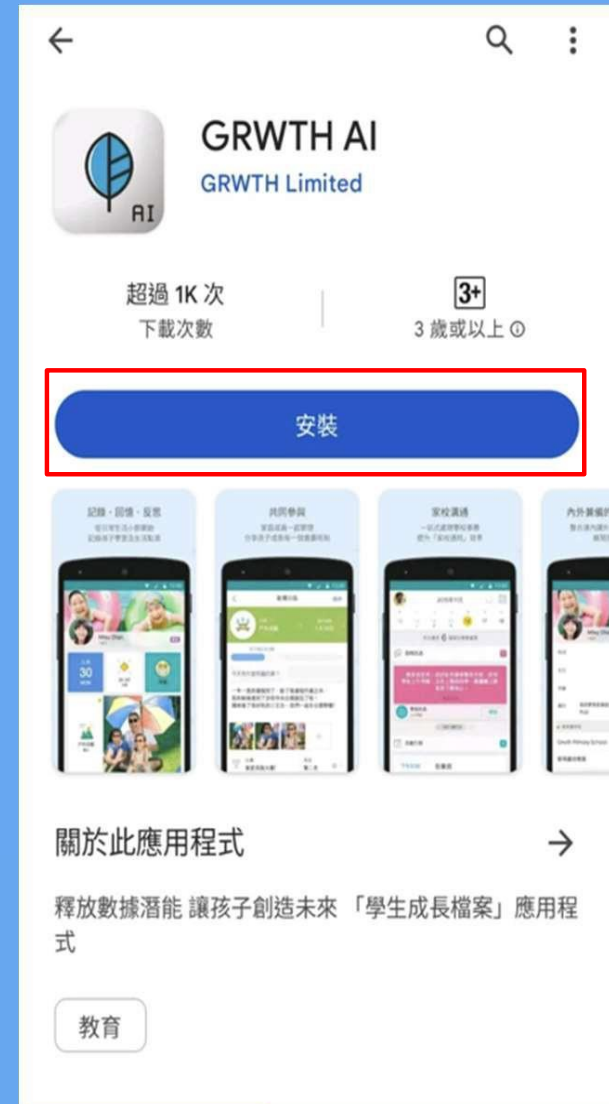



## 步驟四：完成下載後點選「開啟」



## 步驟五：了解注意事項後點選「確定」

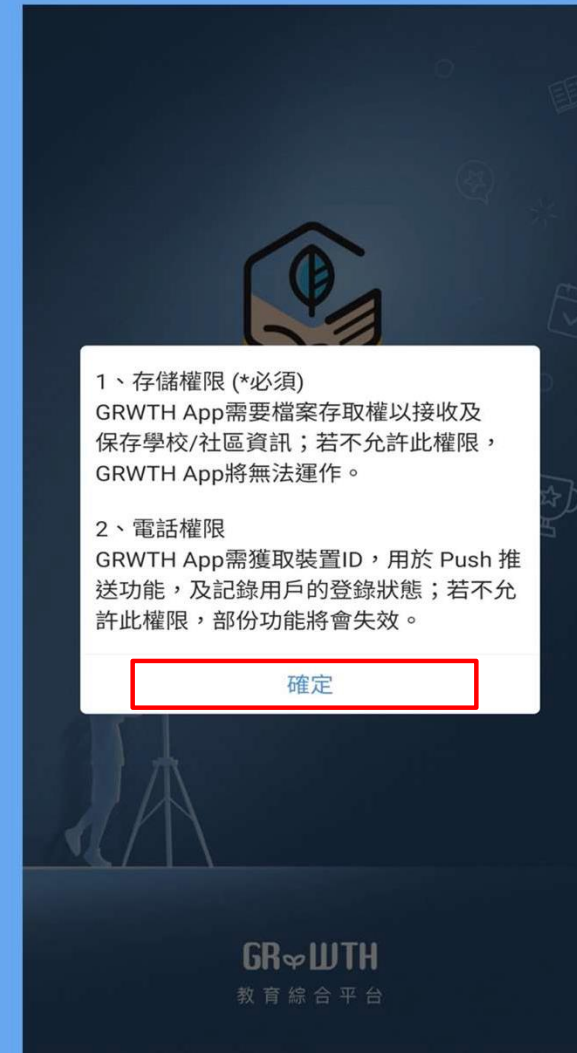

步驟六：於電話權限選項中點選「允許」



步驟七：於相片及媒體權限選項中點選「允許」





步驟八：選擇學校用戶「註冊或登入」



步驟九：家長註冊或登入頁面，如沒有帳號  
按最下方的「用戶註冊」



## 步驟十：可透過手機號碼或其他社交媒體帳號 註冊



註冊

香港 > 請輸入8位手機號碼

請輸入短訊內的驗證碼 [獲取驗證碼](#)

註冊

或使用以下帳號註冊

 **學校帳號**  
學校或老師可以申請成為Grwth用戶 [申請](#)



步驟十一：學生登入頁面，學生需輸入學校派發的登入資料後按「→」





## 步驟十二：成功登入後可開始使用





# How to install 'GRWTH AI' (for Android)



## Step 1: Login to Google Play Store





## Step 2: Search 'Grwth AI'

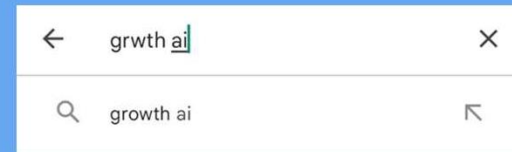





## Step 3: Click 'Install'

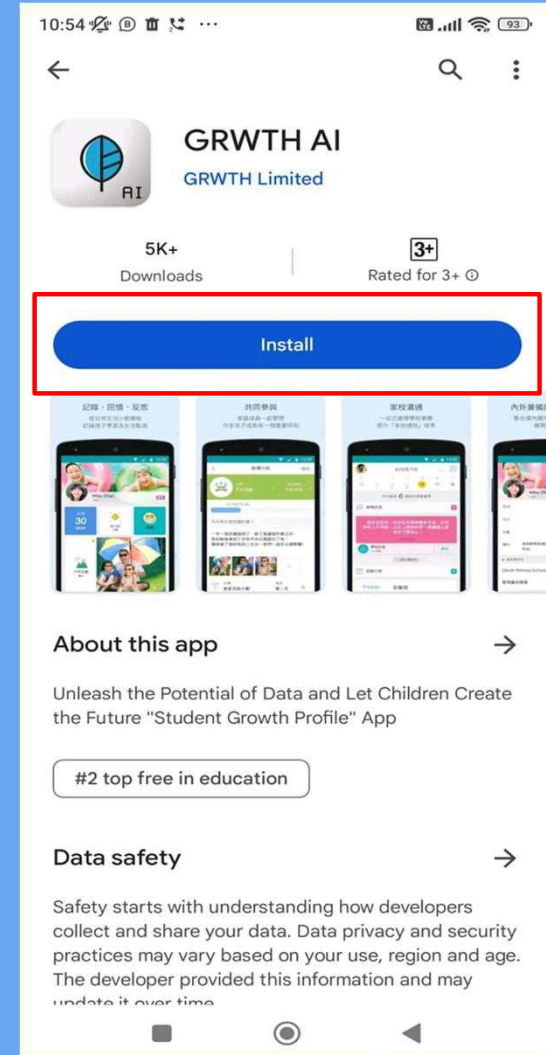



**Step 4: Click 'Open' once download is completed**

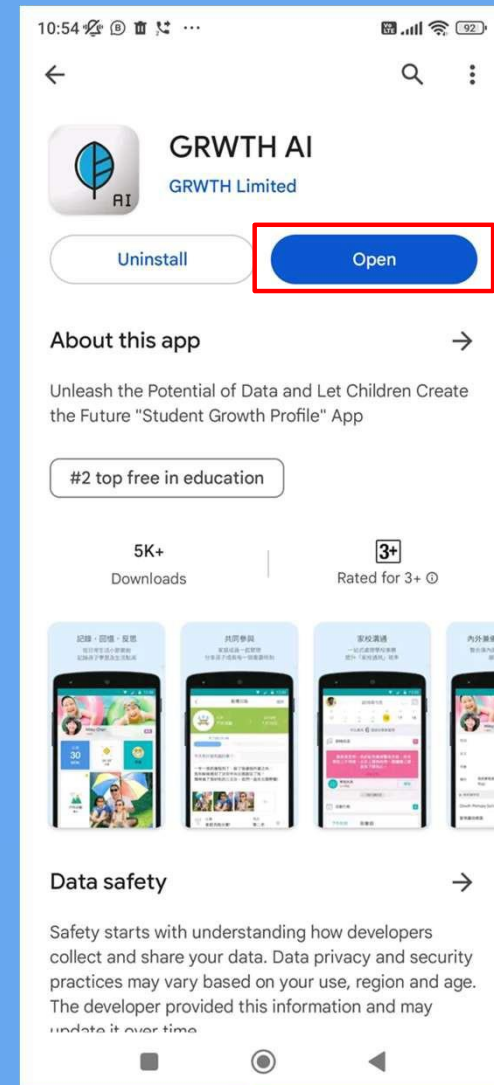



## Step 5: Click 'OK' after reading the accessibility prompt

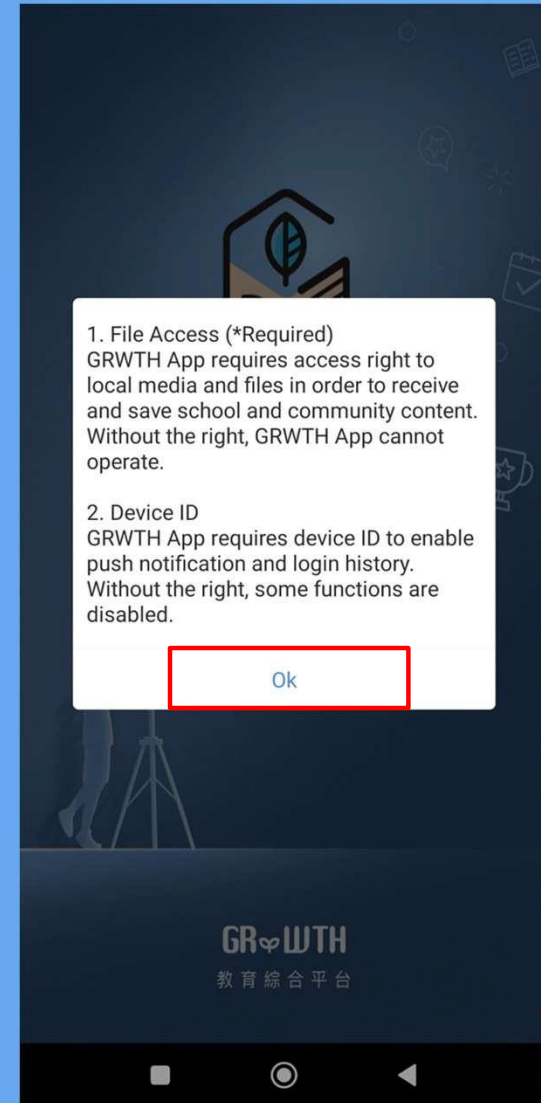



**Step 6: Click 'Allow' in the phone call permission setting**

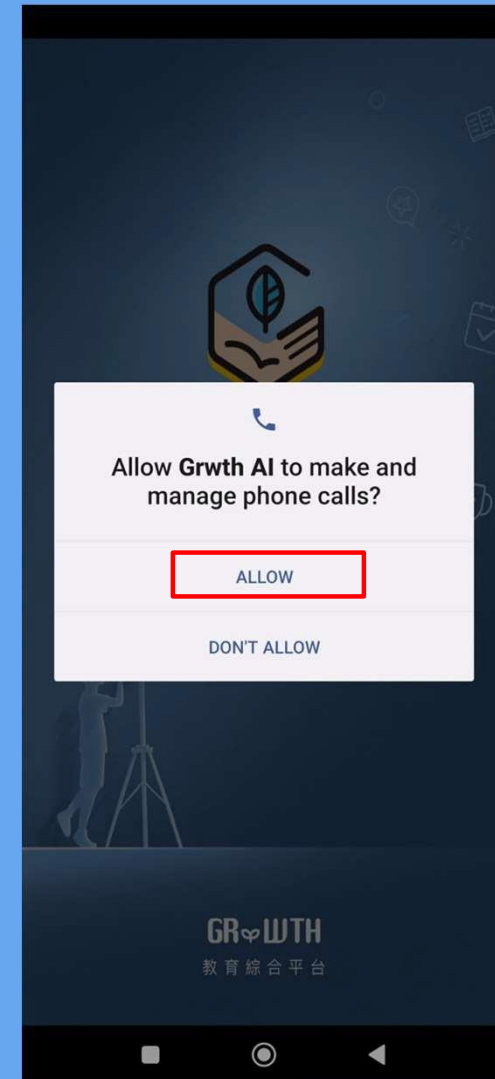



**Step 7: Click 'Allow' in the photos and media permission setting**

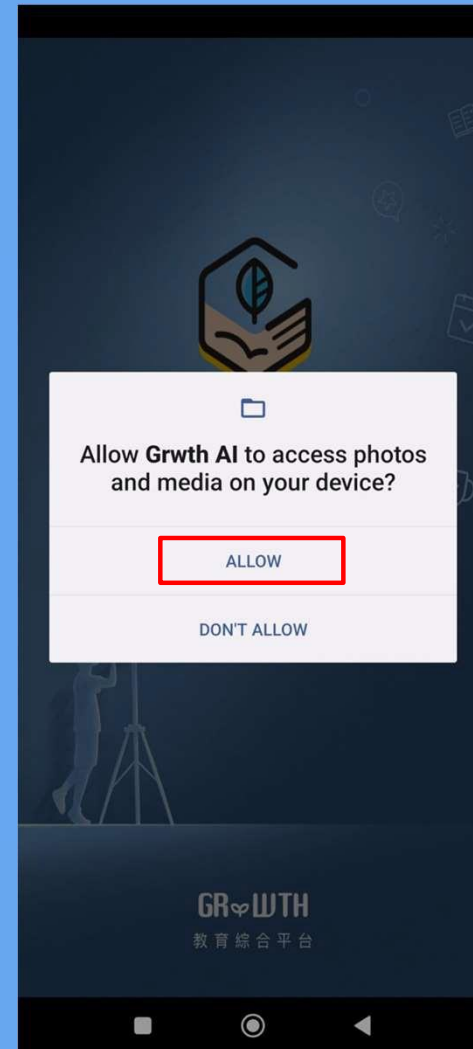

**Step 8: Select 'Register/Login' under 'School User'**

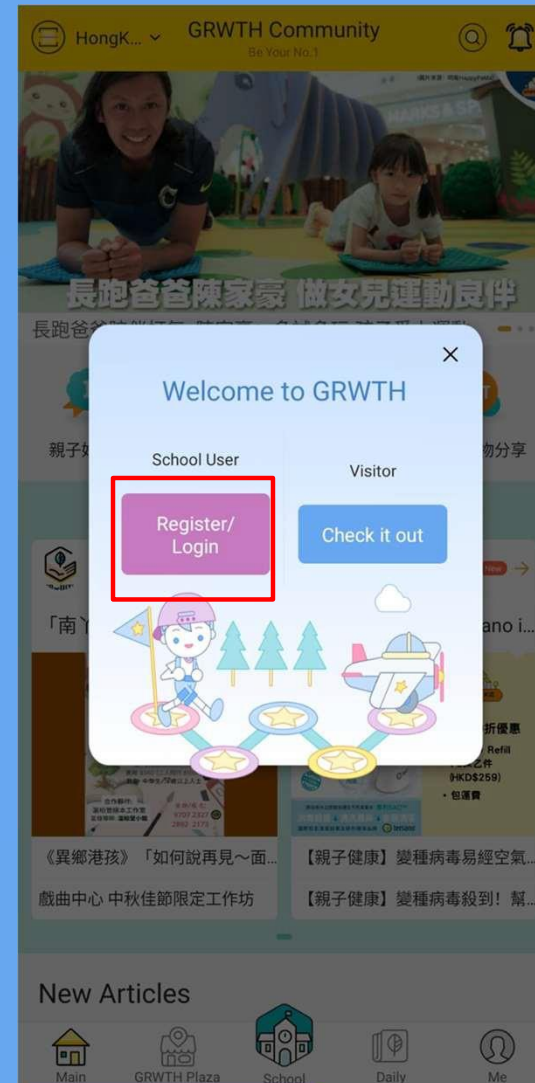



**Step 9: Parent login page. If you do not have an account, click on 'Register' in the bottom**

GRWTH

Parent/Visitor Student Teacher

HK > 8-digit Mobile

Password [Forgot Password](#)

Login

Or choose one of below social login

WhatsApp Google

or Register by Mobile.

Register



**Step 10: Can be registered by mobile phone number or other social media accounts**



Register

HK > 8-digit Mobile

Input the 4-digit code      Validation Code

Register

Use the following account registration.

 The school account  
Schools or teachers may apply for GRWTH [Apply](#)





**Step 11: Student login page. Enter the registered login details provided by the school, then click '→' to login**

A screenshot of the GRWTH mobile application's student login page. The page has a teal header with the GRWTH logo and a navigation bar with three options: "Parent/Visitor", "Student" (which is highlighted with a white arrow), and "Teacher". Below the header, there are two input fields: "Username" and "Password". The "Password" field has a "Forgot Password" link to its right. A blue button with a white right-pointing arrow is positioned below the input fields. Below the button, there is a section for social login with the text "Or choose one of below social login" and a circular icon containing the Google logo.



## Step 5 : Start using the APP after logged-in

